



# REIT Week<sup>®</sup> 2011

June 7-9

Waldorf=Astoria, New York, NY NAREIT's Investor Forum

## Onsite Program

June 7-9

New York, NY

REIT.com<sup>™</sup>  
All Things REIT<sup>™</sup>

REIT  
INVESTMENT  
REIT

Scan this QR Code  
to download the  
REITWeek App now!



Thank you for attending  
REITWeek 2011: NAREIT's  
Investor Forum®. We hope  
you enjoy your time at this  
valuable industry event.

In addition to the  
information provided here,  
be sure to visit [REIT.com](http://REIT.com)  
for webcasts of company  
presentations and session  
replays, as well as  
coverage of the event.



Scan this QR code to  
download the REITWeek  
2011® Mobile App!



© Copyright 2011

**National Association of Real Estate Investment Trusts®**

*REITs: Building Dividends and Diversification®*

1875 I Street, NW, Suite 600, Washington, D.C. 20006-5413

202-739-9400, 800-3NAREIT • 202-739-9401 fax

[REIT.com](http://REIT.com)

# General Information

## Registration Hours

Empire (*Lobby Level*)

Monday, June 6	3:00pm – 5:00pm
Tuesday, June 7	7:00am – 5:00pm
Wednesday, June 8	7:00am – 5:00pm
Thursday, June 9	7:30am – 10:30am

## Networking Room Hours

Hilton (*Lobby Level*)

Tuesday, June 7	7:00am – 5:00pm
Wednesday, June 8	7:00am – 5:00pm
Thursday, June 9	7:30am – 10:30am

## REITPAC Suite Hours (*by invitation-badge required*)

Louis XVI (*4th Floor*)

Tuesday, June 7	8:00am – 5:00pm
Wednesday, June 8	8:00am – 5:00pm
Thursday, June 9	8:00am – 10:00am

## Press Room Hours

New Amsterdam (*18th Floor*)

Tuesday, June 7	8:00am – 5:00pm
Wednesday, June 8	8:00am – 5:00pm
Thursday, June 9	8:00am – 10:00am

## NAREIT Internet Café

Empire (*Lobby Level*)

Need to check and/or send an email? Need to locate something on the web? Visit the Internet Café at NAREIT registration. Open during registration hours.

## NAREIT Resource Center

Available this year through the REITWeek Mobile App! For iPhones, download the App through the App Store; for all other smartphone users, go to:  
<http://reit.com/REITWeek2011/Questions/MobileAppQuestions>

## Attire

Business attire is appropriate for all functions during REITWeek 2011®.

## Security

An official badge is required to participate in or enter any REITWeek® activity, including the Networking Room, REITPAC Suite, Individual Company Presentations and all meal functions.

## Waldorf=Astoria Business Center

Main Lobby

Hours of Operation: 6:00am – 11:00pm daily

# Presenting Companies

The following REITs and listed real estate companies are scheduled to make presentations at REITWeek 2011: NAREIT's Investor Forum®.

**Acadia Realty Trust**

*Wed., 3:45pm, Basildon*

**Agree Realty Corporation**

*Tues., 3:00pm, Duke of Windsor*

**Alexandria Real Estate Equities, Inc.**

*Wed., 11:00am, Astor*

**American Assets Trust**

*Tues., 4:30pm, Duke of Windsor*

**American Campus Communities, Inc.**

*Tues., 8:00am, Astor*

**American Realty Capital Properties, Inc.**

*Wed., 11:45am, Conrad*

**American Realty Capital Trust**

*Tues., 9:30am, Duke of Windsor*

**American Tower Corporation**

*Wed., 11:45am, Jade*

**Annaly Capital Management, Inc.**

*Tues., 2:15pm, Jade*

**Apollo Commercial Real Estate Finance, Inc.**

*Tues., 3:00pm, Conrad*

**Ashford Hospitality Trust, Inc.**

*Tues., 8:00am, Duke of Windsor*

**Associated Estates Realty Corporation**

*Wed., 8:45am, Duke of Windsor*

**AvalonBay Communities, Inc.**

*Tues., 3:00pm, Astor*

**BioMed Realty Trust, Inc.**

*Tues., 11:45am, Astor*

**Broadstone Net Lease, Inc.**

*Wed., 8:45am, Conrad*

**Brookfield Office Properties**

*Wed., 9:30am, Astor*

**CapLease, Inc.**

*Wed., 4:30pm, Conrad*

**CBL & Associates Properties, Inc.**

*Tues., 8:45am, Astor*

**Cedar Shopping Centers, Inc.**

*Wed., 3:00pm, Basildon*

**Chatham Lodging Trust**

*Wed., 3:00pm, Conrad*

**Chimera Investment Corporation**

*Tues., 8:00am, Jade*

**Cogdell Spencer ERDMAN**

*Tues., 11:45am, Conrad*

**Colonial Properties Trust**

*Tues., 8:45am, Basildon*

**Colony Financial, Inc.**

*Wed., 11:00am, Conrad*

**Commonwealth REIT**

*Wed., 8:00am, Duke of Windsor*

**Corporate Office Properties Trust**

*Tues., 2:15pm, Basildon*

**Cousins Properties Incorporated**

*Wed., 8:45am, Basildon*

**CREXUS Investment Corp.**

*Tues., 8:45am, Conrad*

**Cypress Sharpridge Investments, Inc.**

*Tues., 11:45am, Basildon*

**DCT Industrial Trust Inc.**

*Tues., 9:30am, Basildon*

**Developers Diversified Realty Corporation**

*Tues., 10:15am, Astor*

**Digital Realty Trust Inc.**

*Wed., 8:00am, Astor*

**DuPont Fabros Technology, Inc.**

*Wed., 3:00pm, Astor*

**EastGroup Properties, Inc.**

*Tues., 11:00am, East Foyer*

**Education Realty Trust, Inc.**

*Wed., 2:15pm, Conrad*

**Equity One, Inc.**

*Tues., 8:00am, Basildon*

**Equity Residential**

*Wed., 9:30am, Jade*

**Essex Property Trust, Inc.**

*Wed., 10:15am, Astor*

**Excel Trust, Inc.**

*Wed., 8:00am, Conrad*

**Extra Space Storage, Inc.**

*Tues., 9:30am, Astor*

**Federal Realty Investment Trust**

*Wed., 10:15am, Jade*

**FelCor Lodging Trust Incorporated**

*Wed., 10:15am, Duke of Windsor*

**First Industrial Realty Trust, Inc.**

*Wed., 9:30am, Conrad*

**First Potomac Realty Trust**

*Wed., 11:45am, Duke of Windsor*

**General Growth Properties, Inc.**

*Wed., 2:15pm, Jade*

**Gladstone Commercial Corporation**

*Wed., 10:15am, Conrad*

**Glimcher Realty Trust**

*Tues., 11:45am, Duke of Windsor*

**Global Logistics Properties**

*Wed., 3:45pm, Duke of Windsor*



**Government Properties Income Trust**

*Tues., 3:45pm, Basildon*

**HCP, Inc.**

*Tues., 4:30pm, Jade*

**Health Care REIT, Inc.**

*Wed., 8:00am, Jade*

**Highwoods Properties, Inc.**

*Tues., 11:00am, Astor*

**Home Properties, Inc.**

*Wed., 3:45pm, Jade*

**Hospitality Properties Trust**

*Wed., 8:00am, Basildon*

**Host Hotels & Resorts, Inc.**

*Tues., 3:45pm, Jade*

**Hudson Pacific Properties, Inc.**

*Tues., 8:00am, Conrad*

**Inland American Real Estate Trust, Inc.**

*Wed., 3:45pm, Conrad*

**Inland Real Estate Corporation**

*Wed., 11:00am, Basildon*

**Invesco Mortgage Capital Inc.**

*Tues., 10:15am, Duke of Windsor*

**Kilroy Realty Corporation**

*Tues., 3:00pm, Basildon*

**Kimco Realty Corporation**

*Tues., 8:45am, Jade*

**Kite Realty Group Trust**

*Wed., 4:30pm, Duke of Windsor*

**Land Securities Group PLC**

*Wed., 11:00am, Duke of Windsor*

**Lexington Realty Trust**

*Wed., 3:45pm, Astor*

**Liberty Property Trust**

*Wed., 8:45am, Jade*

**MAA**

*Tues., 10:15am, East Foyer*

**Macerich**

*Tues., 2:15pm, Astor*

**MHI Hospitality Corporation**

*Tues., 4:30pm, Conrad*

**Monmouth Real Estate Investment Corporation**

*Tues., 9:30am, Conrad*

**National Retail Properties, Inc.**

*Tues., 11:00am, Basildon*

**Parkway Properties, Inc.**

*Tues., 8:45am, Duke of Windsor*

**Pennsylvania Real Estate Investment Trust**

*Tues., 3:45pm, Duke of Windsor*

**Piedmont Office Realty Trust, Inc.**

*Tues., 10:15am, Basildon*

**Plum Creek Timber Company, Inc.**

*Wed., 11:00am, Jade*

**Potlatch Corporation**

*Tues., 2:15pm, Duke of Windsor*

**ProLogis/AMB Property Corporation**

*Tues., 11:45am, East Foyer*

**PS Business Parks, Inc.**

*Tues., 4:30pm, Basildon*

**Public Storage**

*Wed., 11:45am, Astor*

**RAIT Financial Trust**

*Wed., 3:00pm, Duke of Windsor*

**Ramco-Gershenson Properties Trust**

*Wed., 2:15pm, Duke of Windsor*

**Rayonier Inc.**

*Tues., 11:45am, Jade*

**Regency Centers Corporation**

*Wed., 11:45am, Basildon*

**Sabra Health Care REIT, Inc.**

*Tues., 2:15pm, Conrad*

**Senior Housing Properties Trust**

*Wed., 10:15am, Basildon*

**Simon Property Group, Inc.**

*Tues., 3:00pm, Jade*

**SL Green Realty Corp.**

*Wed., 2:15pm, Astor*

**Strategic Hotels & Resorts, Inc.**

*Wed., 9:30am, Duke of Windsor*

**Tanger Factory Outlet Centers, Inc.**

*Tues., 9:30am, Jade*

**Taubman Centers, Inc.**

*Wed., 9:30am, Basildon*

**Thomas Properties Group Inc.**

*Tues., 3:45pm, Conrad*

**UMH Properties, Inc.**

*Tues., 10:15am, Conrad*

**U-Store-It Trust**

*Wed., 2:15pm, Basildon*

**Ventas, Inc.**

*Tues., 3:45pm, Astor*

**Vornado Realty Trust**

*Wed., 3:00pm, Jade*

**W.P. Carey & Co. LLC**

*Wed., 4:30pm, Astor*

**Washington Real Estate Investment Trust**

*Tues., 4:30pm, Astor*

**Weingarten Realty Investors**

*Wed., 8:45am, Astor*

**Westfield Group**

*Wed., 4:30pm, Jade*

**Weyerhaeuser**

*Tues., 11:00am, Jade*

# Sponsors



NAREIT would like to thank the following sponsors for their generous contributions in support of REITWeek 2011: NAREIT's Investor Forum®.

## Global

Eastdil Secured

## Platinum

Bank of America Merrill Lynch  
Credit Suisse  
FBR Capital Markets  
J.P. Morgan  
Morgan Stanley  
Raymond James  
Stifel Nicolaus Weisel  
UBS

## Conference

Barclays Capital  
BMO Capital Markets  
Citi  
Evercore Partners  
Fitch Ratings  
Goldman, Sachs & Co.  
Greenhill & Co., LLC  
Green Street Advisors  
ISI Group  
Keefe, Bruyette & Woods  
KeyBanc Capital Markets / KeyBank Real Estate Capital  
Moody's Investors Service  
Morgan Keegan & Co., Inc.  
RBC Capital Markets  
RealFoundations  
Robert W. Baird & Co.  
Standard & Poor's Ratings Services

## Media

CAIA Association  
Commercial Property Executive  
Globe St.com  
IREN  
Real Estate Finance & Investment  
Real Estate Forum  
Real Estate Investment Smart Brief  
REIT.com  
REIT magazine®  
REIT Wrap  
SNL Securities  
The Institutional Real Estate Letter



# Schedule of Events

All REITWeek 2011® participants must have an official REITWeek badge in order to participate in any of the scheduled activities.

## Monday June 6

---

**3:00pm – 5:00pm ~ Registration/Internet Café**

Empire (*Lobby Level*)

## Tuesday June 7

---

**7:00am – 5:00pm ~ Registration/Internet Café**

Empire (*Lobby Level*)

**7:00am – 5:00pm ~ Networking Room**

Hilton (*Lobby Level*)

**7:00am – 9:00am ~ Continental Breakfast**

Hilton (*Lobby Level*)

**8:00am – 5:00pm ~ Press Room**

New Amsterdam (*18th Floor*)

**8:00am – 5:00pm ~ REITPAC Suite** (*by invitation-badge required*)

Louis XVI (*4th Floor*)

**8:00am – 8:30am ~ Individual Company Presentations**

**American Campus Communities, Inc.**

- William Bayless, President & CEO
- Karin Ford, Director, KeyBanc Capital Markets Inc.

Astor (*3rd Floor*)

**Ashford Hospitality Trust, Inc.**

- Montgomery Bennett, CEO
- David Loeb, Managing Director, Robert W. Baird & Co.

Duke of Windsor (*4th Floor*)

**Chimera Investment Corporation**

- Matthew Lambiase, President & CEO

Jade (*3rd Floor*)

**Equity One, Inc.**

- Mark Langer, EVP, CFO & CAO
- Richard Milligan, Associate Analyst, Raymond James & Associates, Inc.

Basildon (*3rd Floor*)

**Hudson Pacific Properties, Inc.**

- Victor Coleman, Chairman & CEO  
Conrad (4th Floor)

**8:30am – 11:00am ~ Executive Board Meeting**

- (closed meeting)  
Herbert Hoover (4th Floor)

**8:45am – 9:15am ~ Individual Company Presentations**

**CBL & Associates Properties, Inc.**

- Stephen Lebovitz, President & CEO
- Richard Moore, Research Analyst, RBC Capital Markets  
Astor (3rd Floor)

**Colonial Properties Trust**

- Thomas Lowder, Chairman & CEO
- Jana Galan, VP & Research Analyst, Bank of America  
Merrill Lynch  
Basildon (3rd Floor)

**CREXUS Investment Corp.**

- Kevin Riordan, President & CEO  
Conrad (4th Floor)

**Kimco Realty Corporation**

- David Henry, President, CEO & Vice Chairman
- Ross Smotrich, Managing Director, Barclays Capital  
Jade (3rd Floor)

**Parkway Properties, Inc.**

- Steven Rogers, President & CEO  
Duke of Windsor (4th Floor)

**9:30am – 10:00am ~ Individual Company Presentations**

**American Realty Capital Trust**

- Nicholas Schorsch, Chairman & CEO  
Duke of Windsor (4th Floor)

**DCT Industrial Trust Inc.**

- Philip Hawkins, President & CEO
- Shelia McGrath, Managing Director, Keefe, Bruyette & Woods  
Basildon (3rd Floor)

**Extra Space Storage, Inc.**

- Spencer Kirk, Chairman & CEO
- Michael Salinsky, Research Analyst, RBC Capital Markets  
Astor (3rd Floor)



# Schedule of Events

## **Monmouth Real Estate Investment Corporation**

- Eugene Landy, Chairman & President  
Conrad (4th Floor)

## **Tanger Factory Outlet Centers, Inc.**

- Steven Tanger, President & CEO
- Richard Moore, Research Analyst, RBC Capital Markets  
Jade (3rd Floor)

## **10:15am – 10:45am ~ Individual Company Presentations**

### **Developers Diversified Realty Corporation**

- Daniel Hurwitz, President & CEO  
Astor (3rd Floor)

### **Invesco Mortgage Capital Inc**

- Richard King, President & CEO  
Duke of Windsor (4th Floor)

### **MAA**

- H. Eric Bolton, Jr., Chairman & CEO
- Richard Anderson, Managing Director-IBG Research,  
BMO Capital Markets  
East Foyer (3rd Floor)

### **Piedmont Office Realty Trust, Inc.**

- Donald Miller, CEO  
Basildon (3rd Floor)

### **UMH Properties, Inc.**

- Michael Landy, VP-Investments  
Conrad (4th Floor)

## **11:00am – 11:30am ~ Individual Company Presentations**

### **EastGroup Properties, Inc.**

- David Hoster, II, President & CEO
- William Crow, Managing Director-Real Estate Research,  
Raymond James & Associates, Inc.  
East Foyer (3rd Floor)

### **Highwoods Properties, Inc.**

- Edward Fritsch, President & CEO
- Christopher Lucas, Managing Director, Robert W. Baird & Co.  
Astor (3rd Floor)

### **National Retail Properties, Inc**

- Craig Macnab, CEO
- Paul Puryear, Managing Director, Real Estate Research,  
Raymond James & Associates, Inc.  
Basildon (3rd Floor)

## **Weyerhaeuser**

- Patricia Bedient, EVP & CFO  
Jade (3rd Floor)

## **11:45am – 12:15pm ~ Individual Company Presentations**

### **BioMed Realty Trust, Inc.**

- Kent Griffin, Jr., President
- William Crow, Managing Director-Real Estate Research, Raymond James & Associates, Inc.  
Astor (3rd Floor)

### **Cogdell Spencer ERDMAN**

- Raymond Braun, President & CEO
- William Horne, Jr., VP-Real Estate Research, Raymond James & Associates, Inc.  
Conrad (4th Floor)

### **Cypress Sharpridge Investments, Inc.**

- Kevin Grant, President & CEO  
Basildon (3rd Floor)

### **Glimcher Realty Trust**

- Michael Glimcher, Chairman & CEO
- Todd Thomas, Sr. Analyst, KeyBanc Capital Markets Inc.  
Duke of Windsor (4th Floor)

### **ProLogis/AMB Property Corporation**

- Walter Rackowich, CEO/  
Hamid Moghadam, Chairman & CEO
- George Auerbach, Associate Managing Director, ISI Group  
East Foyer (3rd Floor)

### **Rayonier, Inc.**

- Paul Boynton, President & COO
- Daniel Cooney, AVP, Keefe, Bruyette & Woods  
Jade (3rd Floor)

## **12:30pm – 2:00pm ~ Opening Luncheon General Session**

Grand Ballroom (3rd Floor)



Bryce Blair

### **NAREIT Chair's Remarks:**

Bryce Blair, Chairman & CEO,  
AvalonBay Communities, Inc.



### **Keynote Speaker:**

Nouriel Roubini, Professor of Economics, New York University, Stern School of Business and Chairman / Founder, Roubini Global Economics

# Schedule of Events

## 2:15pm – 2:45pm ~ Individual Company Presentations

### **Annaly Capital Management, Inc.**

- Michael Farrell, Chairman, President & CEO

Jade (3rd Floor)

### **Corporate Office Properties Trust**

- Randall Griffin, CEO
- Steven Sakwa, Sr. Managing Director, ISI Group

Basildon (3rd Floor)

### **Macerich**

- Arthur Coppola, Chairman & CEO
- Craig Schmidt, VP & Research Analyst, Bank of America Merrill Lynch

Astor (3rd Floor)

### **Potlatch Corporation**

- Michael Covey, Chairman, President & CEO
- Daniel Cooney, AVP, Keefe, Bruyette & Woods

Duke of Windsor (4th Floor)

### **Sabra Health Care REIT, Inc.**

- Richard Matros, Chairman & CEO
- Robert Mains, SVP & Sr. Analyst, Morgan Keegan

Conrad (4th Floor)

## 3:00pm – 3:30pm ~ Individual Company Presentations

### **Agree Realty Corporation**

- Joey Agree, President & COO

Duke of Windsor (4th Floor)

### **Apollo Commercial Real Estate Finance, Inc.**

- Stuart Rothstein, CFO
- Joshua Barber, VP, Stifel, Nicolaus & Co., Inc.

Conrad (4th Floor)

### **AvalonBay Communities, Inc.**

- Bryce Blair, Chairman & CEO
- Andrew McCulloch, Sr. Analyst, Green Street Advisors, Inc.

Astor (3rd Floor)

### **Kilroy Realty Corporation**

- John Kilroy, Jr., President & CEO
- Steven Sakwa, Sr. Managing Director, ISI Group

Basildon (3rd Floor)

### **Simon Property Group, Inc.**

- David Simon, Chairman & CEO
- Andrew Rosivach, Director - Equities Research, Credit Suisse

Jade (3rd Floor)

**3:45pm – 4:15pm ~ Individual Company Presentations**

**Government Properties Income Trust**

- David Blackman, President & COO
- David Rodgers, Director, REIT Research, RBC Capital Markets  
Basildon (3rd Floor)

**Host Hotels & Resorts, Inc.**

- W. Edward Walter, President & CEO
- William Crow, Managing Director-Real Estate Research,  
Raymond James & Associates, Inc.  
Jade (3rd Floor)

**Pennsylvania Real Estate Investment Trust**

- Edward Glickman, President & COO
- Nathan Isbee, VP, Stifel, Nicolaus & Co., Inc.  
Duke of Windsor (4th Floor)

**Thomas Properties Group Inc.**

- James Thomas, Chairman, President & CEO
- David Loeb, Managing Director, Robert W. Baird & Co.  
Conrad (4th Floor)

**Ventas, Inc.**

- Debra Cafaro, Chairman & CEO
- Jerry Doctrow, Managing Director, Stifel, Nicolaus & Co., Inc.  
Astor (3rd Floor)

**4:30pm – 5:00pm ~ Individual Company Presentations**

**American Assets Trust**

- Robert Barton, CFO
- Matthew Johnson, Executive Director, Morgan Stanley  
Duke of Windsor (4th Floor)

**HCP, Inc.**

- James Flaherty, III, Chairman & CEO  
Jade (3rd Floor)

**MHI Hospitality Corporation**

- Andrew Sims, Chairman, President & CEO  
Conrad (4th Floor)

**PS Business Parks, Inc.**

- Joseph Russell, President & CEO
- Andrew Rosivach, Director-Equities Research, Credit Suisse  
Basildon (3rd Floor)

**Washington Real Estate Investment Trust**

- George McKenzie, President & CEO
- Brendan Maiorana, Sr. Research Analyst, Wells Fargo  
Securities LLC  
Astor (3rd Floor)

# Schedule of Events

**6:00pm – 9:00pm ~ Board of Governors Dinner** *(invitation only)*  
Waldorf=Astoria ~ Starlight Roof (18th Floor)



Niall Ferguson

**Speaker:**

Niall Ferguson, Laurence A. Tisch Professor of History, Harvard University and William Ziegler Professor of Business Administration, Harvard Business School

## Wednesday June 8

**7:00am – 5:00pm ~ Registration/Internet Café**  
Empire *(Lobby Level)*

**7:00am – 5:00pm ~ Networking Room**  
Hilton *(Lobby Level)*

**7:00am – 9:00am ~ Continental Breakfast**  
Hilton *(Lobby Level)*

**7:15am – 8:30am ~ Real Estate Investment Advisory Council Breakfast** *(closed meeting)*  
Starlight Roof (18th Floor)

**8:00am – 5:00pm ~ Press Room**  
New Amsterdam *(18th Floor)*

**8:00am – 5:00pm ~ REITPAC Suite** *(by invitation-badge required)*  
Louis XVI *(4th Floor)*

**8:00am – 8:30am ~ Individual Company Presentations**

**CommonWealth REIT**

- Adam Portnoy, President & Managing Trustee
- Stephen Swett, Managing Director & Sr. Analyst, Morgan Keegan & Co., Inc.

Duke of Windsor *(4th Floor)*

**Digital Realty Trust Inc.**

- Michael Foust, CEO
- John Stewart, Analyst, Green Street Advisors, Inc.

Astor *(3rd Floor)*

**Excel Trust, Inc.**

- Gary Sabin, Chairman & CEO

Conrad *(4th Floor)*

## **Health Care REIT, Inc.**

- George Chapman, Chairman, President & CEO  
Jade (3rd Floor)

## **Hospitality Properties Trust**

- John Murray, President & COO
- Smedes Rose, VP-Equity Research, Lodging & Gaming, Keefe, Bruyette & Woods  
Basildon (3rd Floor)

## **8:45am – 9:15am ~ Individual Company Presentations**

### **Associated Estates Realty Corporation**

- Jeffrey Friedman, Chairman, President & CEO
- Andrew McCulloch, Sr. Analyst, Green Street Advisors, Inc.  
Duke of Windsor (4th Floor)

### **Broadstone Net Lease, Inc.**

- Amy Tait, CEO  
Conrad (4th Floor)

### **Cousins Properties Incorporated**

- Lawrence Gellerstedt, III, President & CEO
- Brendan Maiorana, Sr. Research Analyst, Wells Fargo Securities LLC  
Basildon (3rd Floor)

### **Liberty Property Trust**

- William Hankowsky, Chairman, President & CEO
- Paul Adornato, Managing Director-IBG Research, BMO Capital Markets  
Jade (3rd Floor)

### **Weingarten Realty Investors**

- Andrew Alexander, President & CEO
- Quentin Velleley, VP, Citi  
Astor (3rd Floor)

## **9:30am – 10:00am ~ Individual Company Presentations**

### **Brookfield Office Properties**

- Richard Clark, President & CEO
- Jay Habermann, VP & Sr. Research Analyst, Goldman Sachs & Co.  
Astor (3rd Floor)

### **Equity Residential**

- David Neithercut, President & CEO
- Andrew McCulloch, Sr. Analyst, Green Street Advisors, Inc.  
Jade (3rd Floor)



# Schedule of Events

## **First Industrial Realty Trust, Inc.**

- Bruce Duncan, President & CEO  
Conrad (4th Floor)

## **Strategic Hotels & Resorts, Inc.**

- Laurence Geller, President & CEO
- Jeffrey Donnelly, Managing Director-Equity Research, Wells Fargo Securities LLC  
Duke of Windsor (4th Floor)

## **Taubman Centers, Inc.**

- Robert Taubman, Chairman, President & CEO
- Cedrik LaChance, Managing Director, Green Street Advisors, Inc.  
Basildon (3rd Floor)

## **10:15am – 10:45am ~ Individual Company Presentations**

### **Essex Property Trust, Inc.**

- Michael Schall, President & CEO
- Anthony Paolone, Executive Director, JP Morgan  
Astor (3rd Floor)

### **Federal Realty Investment Trust**

- Donald Wood, President & CEO
- Jeffrey Spector, Managing Director & Sr. Research Analyst, Bank of America Merrill Lynch  
Jade (3rd Floor)

### **FelCor Lodging Trust Incorporated**

- Richard Smith, President & CEO
- Eli Hackel, Research Analyst, Goldman, Sachs & Co.  
Duke of Windsor (4th Floor)

### **Gladstone Commercial Corporation**

- David Gladstone, Chairman & CEO  
Conrad (4th Floor)

### **Senior Housing Properties Trust**

- David Hegarty, President & COO
- Todd Stender, VP-Equity Research, Wells Fargo Securities LLC  
Basildon (3rd Floor)

## **11:00am – 11:30am ~ Individual Company Presentations**

### **Alexandria Real Estate Equities, Inc.**

- Krupal Raval, SVP-Capital Markets
- Anthony Paolone, Executive Director, J.P Morgan  
Astor (3rd Floor)

**Colony Financial, Inc.**

- Richard Saltzman, CEO
- Conrad (4th Floor)

**Inland Real Estate Corporation**

- Mark Zalatoris, President & CEO
- Basildon (3rd Floor)

**Land Securities Group PLC**

- Francis Salway, Chief Executive
- Duke of Windsor (4th Floor)

**Plum Creek Timber Company, Inc.**

- Rick Holley, President & CEO
  - Daniel Cooney, AVP, Keefe, Bruyette & Woods
- Jade (3rd Floor)

**11:45am – 12:15pm ~ Individual Company Presentations**

**American Realty Capital Properties, Inc.**

- Nicholas Schorsch, Chairman & CEO
- Conrad (4th Floor)

**American Tower Corporation**

- James Taiclet, Chairman, President & CEO
  - Richard Prentiss, Managing Director, Raymond James & Associates, Inc.
- Jade (3rd Floor)

**First Potomac Realty Trust**

- Douglas Donatelli, Chairman & CEO
  - Brendan Maiorana, Sr. Research Analyst, Wells Fargo Securities LLC
- Duke of Windsor (4th Floor)

**Public Storage**

- Ronald Havner, Jr., President & CEO
  - Michael Mueller, Executive Director, JP Morgan
- Astor (3rd Floor)

**Regency Centers Corporation**

- Martin Stein, Jr., Chairman & CEO
  - Quentin Velleley, VP, Citi
- Basildon (3rd Floor)

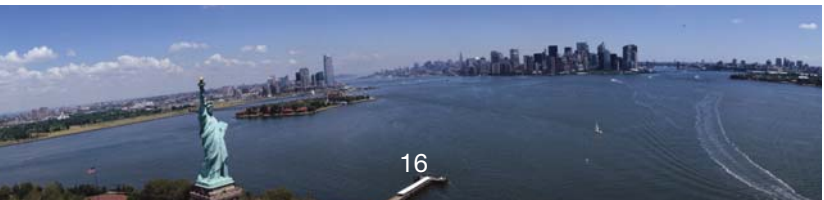

# Schedule of Events

**12:30pm – 2:00pm ~ General Session Luncheon: REIT**

## **Mergers & Acquisitions**

Grand Ballroom (3rd Floor)



### **Welcome Remarks:**

Steven A. Wechsler,  
President & CEO, NAREIT

Steven Wechsler



### **Moderator:**

Jackson Hsieh, Vice Chairman,  
Global Head of Real Estate, Lodging and  
Leisure, UBS Investment Bank

Jackson Hsieh

### **Panelists:**

Debra Cafaro, Chairman & CEO, Ventas, Inc.

Adam Emmerich, Partner, Wachtell Lipton, Rosen & Katz

Matthew Lustig, Vice Chairman of U.S. Investment Banking,  
Head of Real Estate, Lazard Feres & Co. LLC

Walter Rakowich, CEO, ProLogis



Debra Cafaro



Adam Emmerich



Matthew Lustig



Walter Rakowich

**2:15pm – 2:45pm ~ Individual Company Presentations**

### **Education Realty Trust, Inc.**

- Randall Churchey, President & CEO
  - Paula Poskon, Sr. Research Analyst, Robert W. Baird & Co.
- Conrad (4th Floor)

### **General Growth Properties, Inc.**

- Sandeep Mathrani, CEO
- Jade (3rd Floor)

### **Ramco-Gershenson Properties Trust**

- Dennis Gershenson, President & CEO
- Duke of Windsor (4th Floor)

### **SL Green Realty Corp.**

- Marc Holliday, CEO
  - John Guinee, Managing Director, Stifel, Nicolaus & Co., Inc.
- Astor (3rd Floor)

**U-Store-It Trust**

- Dean Jernigan, CEO  
Basildon (3rd Floor)

**3:00pm – 3:30pm ~ Individual Company Presentations**

**Cedar Shopping Centers, Inc.**

- Leo Ullman, Chairman, President & CEO
- Paul Adornato, Managing Director-IBG Research,  
BMO Capital Markets  
Basildon (3rd Floor)

**Chatham Lodging Trust**

- Jeffrey Fisher, Chairman, President & CEO
- C. Patrick Scholes, Senior Equity Research Analyst -  
Gaming & Lodging, FBR Capital Markets & Co., Inc.  
Conrad (4th Floor)

**DuPont Fabros Technology, Inc.**

- Hossein Fateh, President & CEO
- Jordan Sadler, Managing Director, KeyBanc Capital Markets Inc.  
Astor (3rd Floor)

**RAIT Financial Trust**

- Scott Schaeffer, Chairman & CEO
- Gabe Poggi, SVP, FBR Capital Markets & Co., Inc.  
Duke of Windsor (4th Floor)

**Vornado Realty Trust**

- Michael Fascitelli, President & CEO
- Michael Bilerman, Managing Director, Citi  
Jade (3rd Floor)

**3:45pm – 4:15pm ~ Individual Company Presentations**

**Acadia Realty Trust**

- Kenneth Bernstein, President & CEO
- Michael Mueller, Executive Director, J.P. Morgan  
Basildon (3rd Floor)

**Global Logistic Properties**

- Jeffrey Schwartz, Chairman & Co-Founder  
Duke of Windsor (4th Floor)

**Home Properties, Inc.**

- Edward Pettinella, President & CEO
- Michael Bilerman, Managing Director, Citi  
Jade (3rd Floor)

**Inland American Real Estate Trust, Inc.**

- Thomas McGuinness, CEO
- Paul Adornato, Managing Director-IBG Research,  
BMO Capital Markets  
Conrad (4th Floor)

# Schedule of Events

## Lexington Realty Trust

- T. Wilson Eglin, President & CEO
- Todd Stender, VP-Equity Research, Wells Fargo Securities LLC  
Astor (3rd Floor)

## 4:30pm – 5:00pm ~ Individual Company Presentations

## CapLease, Inc.

- Paul McDowell, Chairman & CEO  
Conrad (4th Floor)

## Kite Realty Group Trust

- John Kite, Chairman & CEO
- Todd Thomas, Sr. Analyst, KeyBanc Capital Markets Inc.  
Duke of Windsor (4th Floor)

## W. P. Carey & Co. LLC

- Trevor Bond, President & CEO
- Paul Adornato, Managing Director-IBG Research,  
BMO Capital Markets  
Astor (3rd Floor)

## Westfield Group

- Mark Stefanek, CFO-US  
Jade (3rd Floor)

## Thursday June 9

### 7:30am – 10:30am ~ Registration/Internet Café

Empire (Lobby Level)

### 7:30am – 10:30am ~ Networking Room

Hilton (Lobby Level)

### 8:00am – 10:00am ~ Press Room

New Amsterdam (18th Floor)

### 8:00am – 10:00am ~ REITPAC Suite (by invitation-badge required)

Louis XVI (4th Floor)

### 9:00am – 10:30am ~ Breakfast General Session:

#### Politics and Morning Joe

Grand Ballroom (3rd Floor)

#### Speaker:

Joe Scarborough, Host of MSNBC's  
*Morning Joe* and former Congressman



Joe  
Scarborough

## 2011 Meetings

### Senior Financial Officer/Investor Relations

#### Officer Workshop

September 26 – 27  
Palmer House Hilton  
Chicago, IL

#### HR Forum

October 17 – 18  
The Ritz-Carlton  
McLean, VA

### REITWorld 2011: NAREIT's Annual

#### Convention for All Things REIT®

November 15 – 17  
Hilton Anatole  
Dallas, TX

## 2012 Meetings

### Washington Leadership Forum

February 28 – 29  
St. Regis  
Washington, DC

### REITWise 2012: NAREIT's Law, Accounting & Finance Conference®

March 21 – 23  
Westin Diplomat  
Hollywood, FL

### REITWeek 2012: NAREIT's Investor Forum®

June 12 – 14  
New York Hilton  
New York, NY

### Senior Financial Officer/Investor Relations

#### Officer Workshop

TBD

#### HR Forum

TBD

### REITWorld 2012: NAREIT's Annual

#### Convention for All Things REIT®

November 13 – 15  
Manchester Grand Hyatt  
San Diego, CA

# Thank You Sponsors of REITWeek 2011®

## Global Sponsor



**EASTDIL  
SECURED**

## Platinum Sponsors

**Bank of America**   
**Merrill Lynch**

**CREDIT SUISSE** 

 **FBR**

**J.P. Morgan**

**Morgan Stanley**

**RAYMOND JAMES®**

**STIFEL  
NICOLAUS  
WEISEL**

 **UBS**

## Conference Sponsors



BMO Capital Markets

EVERCORE PARTNERS



FitchRatings

Goldman Sachs

Green Street Advisors

ISI

Greenhill

INTERNATIONAL STRATEGY & INVESTMENT



KEEFE, BRUYETTE & WOODS



MOODY'S  
INVESTORS SERVICE

Morgan  
Keegan



RBC Capital Markets®

real  foundations

BAIRD

STANDARD  
& POOR'S



# Waldorf=Astoria Hotel Maps

## THE WALDORF=ASTORIA - LOBBY LEVEL

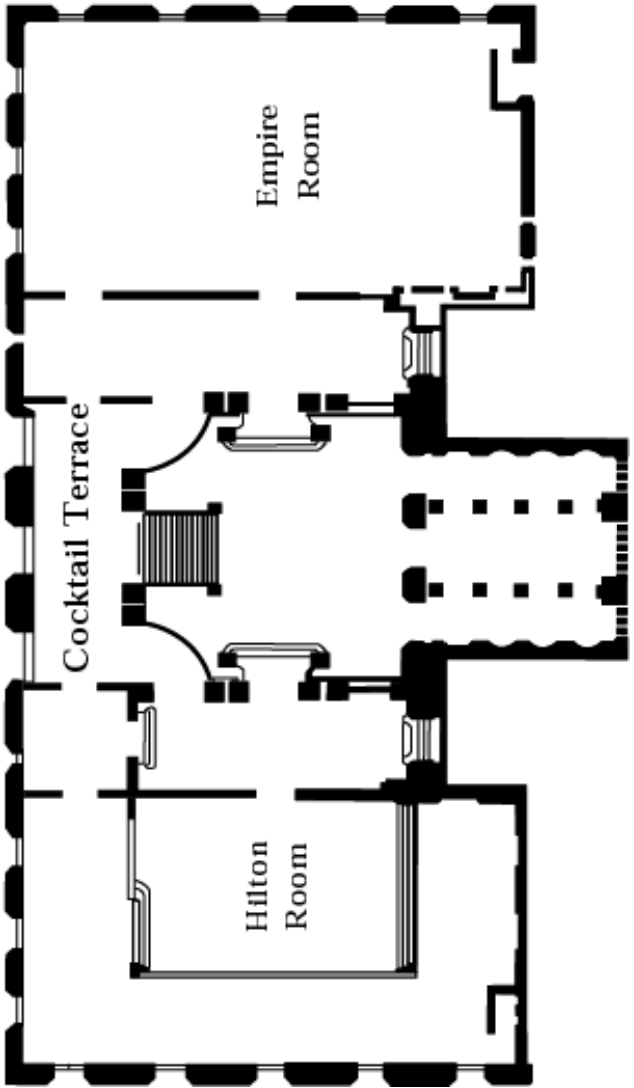

# Waldorf=Astoria Hotel Maps

## THE WALDORF=ASTORIA - THIRD FLOOR

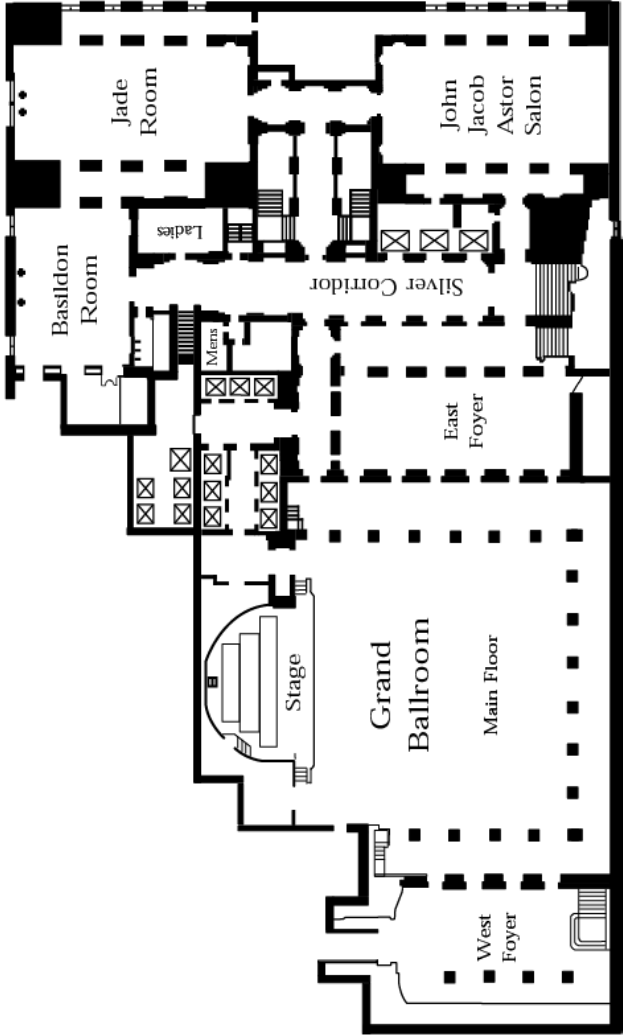

## THE WALDORF=ASTORIA - FOURTH FLOOR

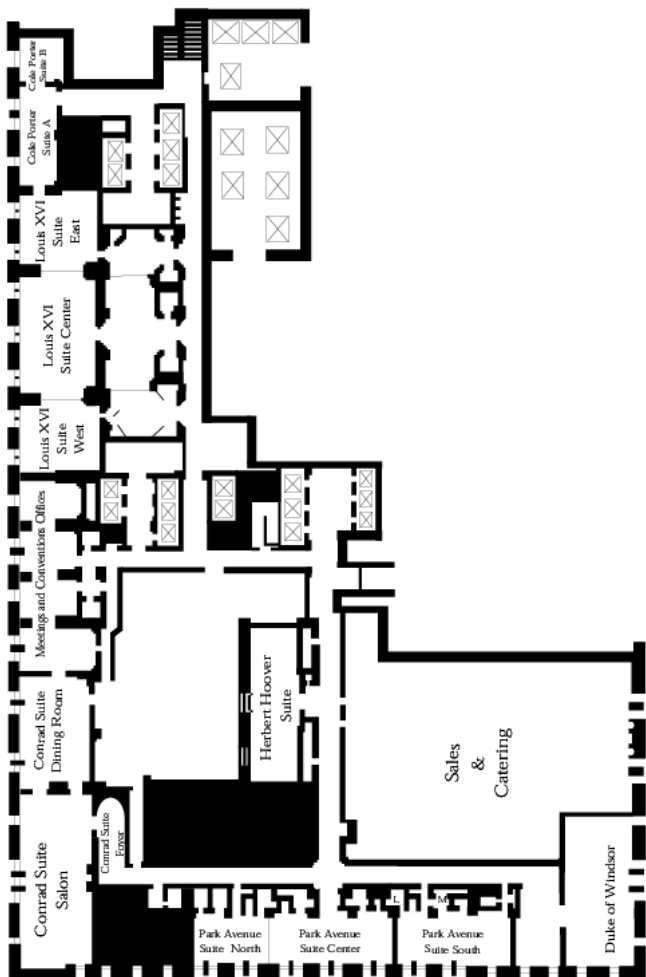

# Waldorf=Astoria Hotel Maps

## THE WALDORF=ASTORIA - EIGHTEENTH FLOOR

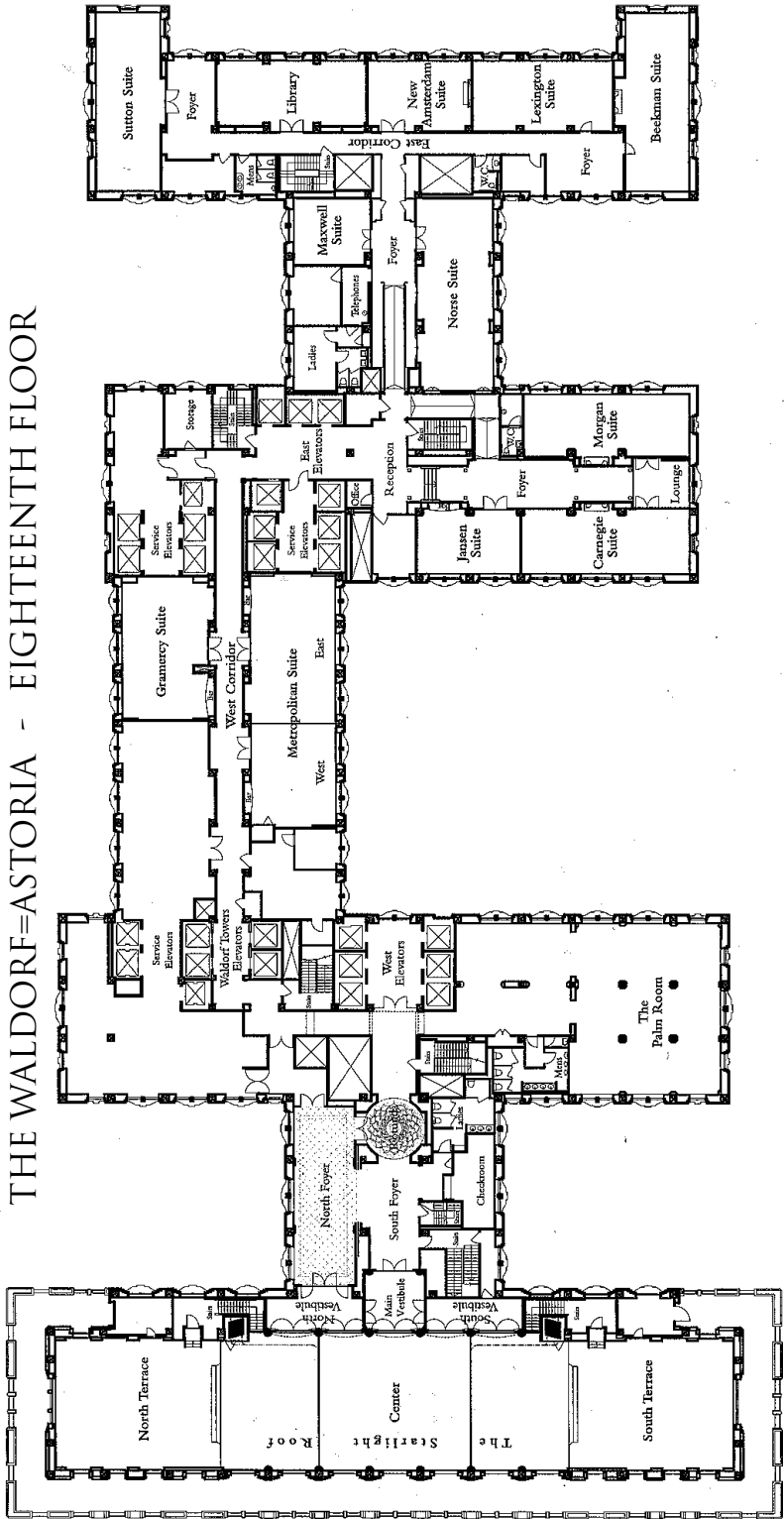



# REIT.com<sup>TM</sup>

## All Things REIT<sup>TM</sup>

Visit **REIT.com** for:

- Breaking REIT and Real Estate Investment News
- Timely and Topical Video Interviews with Industry Leaders
- Investment Stats for Institutional Investors
- Policy, Political and Practice News and Analysis
- Meeting and Event Info

**REIT.com** is brought to you by NAREIT®  
Worldwide Representative Voice for REITs  
and Publicly Traded Real Estate Companies with  
an Interest in U.S. Real Estate and Capital Markets